



myblinds.ie



how to fit and care for your **roman blind**

IN ORDER TO KEEP YOUR BLIND SAFE IN TRANSIT, THE BRACKETS ARE PACKED SEPARATELY AND ENCLOSED AT ONE END OF THE BOX. PLEASE CHECK THOROUGHLY BEFORE DISCARDING ANY PACKAGING.

aftercare

To ensure your Roman blind stays looking its best for many years to come, follow the straightforward operating and cleaning instructions below:

Operating Instructions

- Pull the side chain to raise the blind to the desired level
- Raise blind to your required level, this will automatically stay in this position

Cleaning

- If your blind has a label with the  symbol, then the fabric can be dry cleaned with care. Remove the blind from the headrail and take out the fabric rods and bottom bar
- Soft fabric will shrink - if any of the fibre rods become visible, trim them off to desired length with an appropriate tool
- Alternatively, fabric can be cleaned using the upholstery tool on your vacuum cleaner

WARNING

IN THE INTEREST OF SAFETY, PLEASE KEEP ALL PULL CORDS AND CHAINS OUT OF THE REACH OF CHILDREN. MOVE COTS, BEDS AND OTHER FURNITURE AWAY FROM BLINDS AND INSTALL SAFETY DEVICES SUCH AS CLEATS AND CORD TIDIES TO LIMIT ACCESS TO CORDS.



roman blinds fitting instructions

fittings

- 1 Brackets:
quantity to suit
length of blind

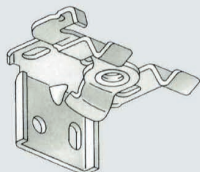

- 2 Wood screws:
min 4



- 3 Screws: min 4



- 4 Blind: 1

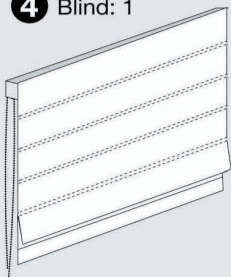

Outside Recess

If fitting the blind outside the window, measurements **(C)** will need to be the same. To work out **(C)**, simply minus **(B)** from **(A)** and divide the answer by two. Follow instructions for FACE FIXING

Inside recess

Decide whether to FACE or TOP FIX. FACE FIX to fit the bracket to the window frame. TOP FIX to the lintel if the window frame is uPVC, or if there are any obstructions, e.g. window handles.

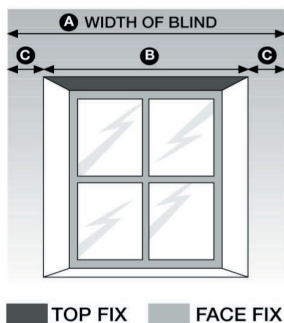

step one

Place blind in fitting position. Space the brackets evenly. Leave 3cm clearance at either end of the rail to prevent interference with side winder mechanism.



B Possible bracket positioning

step two

Top Fixing

Measure the distance that any handles protrude from the frame, **A**. Mark this measurement on the lintel and use it to position the back of the bracket. Mark the position of holes **B** and screw bracket to lintel using screws and rawl plugs supplied.

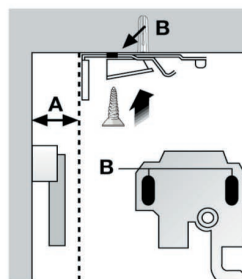

Face Fixing

Position bracket with swing arm facing towards you, and mark holes **B**. Screw bracket in place. Use rawl plugs if fitting to the wall.

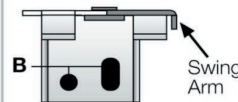

step three

Push swing arm anti-clockwise as far as it will go. Now clip the blind over the bracket, first easing the front lip of the headrail **A** in to place.

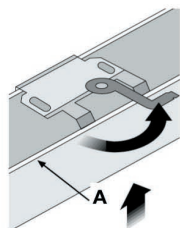

Push swing arm clockwise until it locks in to place, firmly holding the blind headrail.

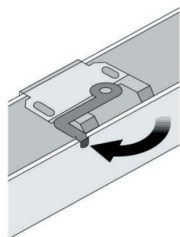

step four

The fabric of the Roman blind is attached to the headrail with velcro.

Pull side chain to raise and lower the blind.

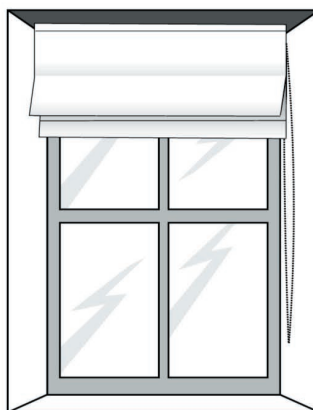

step five